



## **The latest version of Paragon brings new Hotsheet capabilities and more**

**Read about other changes and scheduled downtime below**

We at CRMLS are always working to improve your Paragon experience. On **Wednesday, 12/7**, you'll find an upgraded MLS system experience.

To bring you this advanced version of Paragon, there will be a downtime period from **Tuesday, 12/6, at 10:00 PM PT** until **Wednesday, 12/7, at 6:00 AM PT** – a total timeframe of up to eight hours.

CRMLS Paragon and Paragon Connect updates will include:

### **Hotsheet Alert Save**

You'll be able to set a Hotsheet alert when you save a new search instead of needing to access your saved Hotsheet searches.

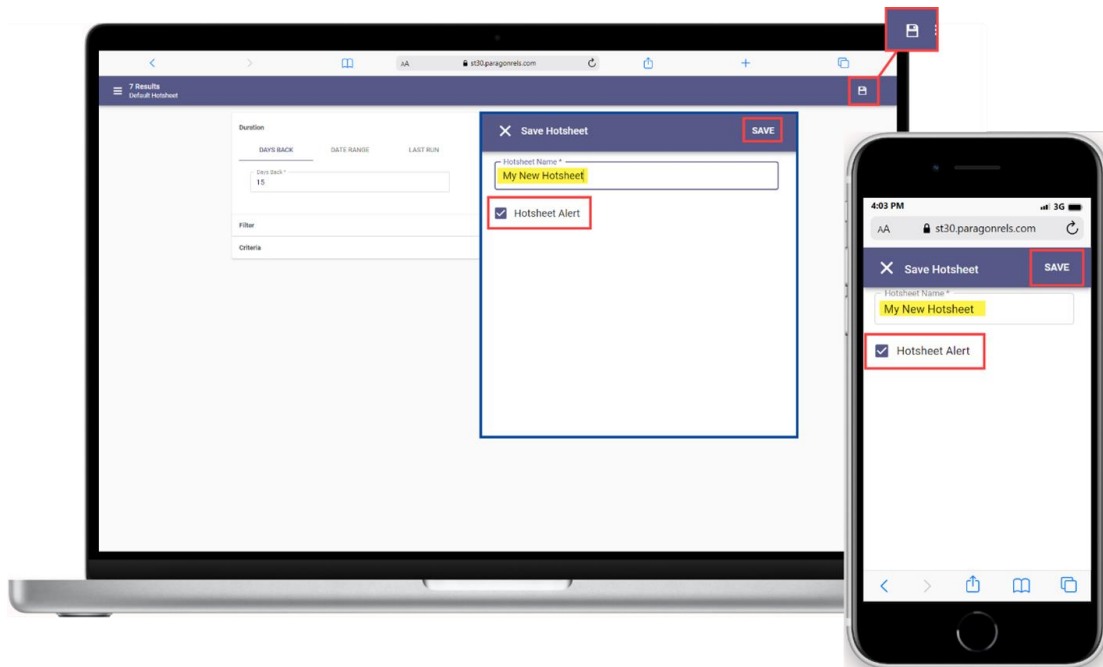

## Contact List Updates

The contact list for Paragon Connect will include three shortcut actions to help you quickly access your client's information. You can use the phone icon to see, call, or text any and all numbers associated with that contact, the email icon to pick which addresses to send a message to, and a quick link icon leading you to the client's Collaboration Center site.

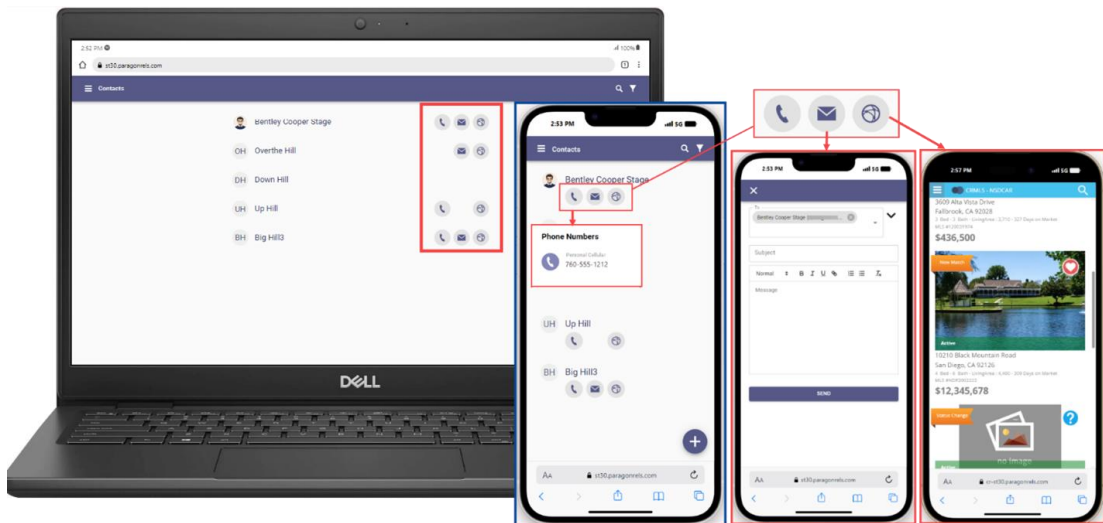

For a full list of everything this Paragon update will bring, [check out our knowledgebase article.](#)

Thank you for your continued support.

California Regional MLS

---

### We've Got You Covered

#### EDUCATION

CRMLS offers a variety of resources to educate you on our products and services. Click above to visit the CRMLS training center.

#### SUPPORT

If you need MLS support, please click above or call us at (800) 925-1525. Our Customer Care team will be happy to assist.

#### COMPLIANCE

We keep your listing data safe, clean, and accurate. Click above to chat live with a CRMLS Compliance representative.

---

### CRMLS Product Discovery Tool

Build out your tech toolbox with these CRMLS products  
- all available at no extra cost.

[Unsubscribe](#)  
[Privacy Policy](#)  
[Get in touch](#)



Copyright © 2022 CRMLS. All rights reserved.



909.859.2040  
15325 Fairfield Ranch Road, Suite 200  
Chino Hills CA 91709